

Roof terrace system, pine finish – GEL+VEA/B/C



Roof terrace system.



The VELUX roof terrace system can be installed in roof pitches between 35° and 53°. The system offers the possibility of creating a roof terrace with access from the building. The number of units installed is according to individual wishes. VELUX do not supply the exterior terrace weathering or railing elements.

The system consists of:

GEL: The top-hung top element opens 45°, barrel bolt for locking the sash in cleaning position, ventilation flap with air filter, control bar.

VEA: Side-hung bottom element opens 90° and is hinged on the left hand side seen from the outside.

VEB: Side-hung bottom element opens 90° and is hinged on the right hand side seen from the outside.

VEC: Fixed bottom element.

The appropriate flashing and the EBY adjustable support trimmer are also supplied as part of the system.

GEL can be opened by means of a handle at the bottom sash. The window opens up to 45°.

The control bar on GEL is used for operating the ventilation flap or for fully rotating the sash for cleaning the exterior pane.

The bottom element is opened by means of a handle at the side sash. When both the top and the bottom element are open, there is free access to the roof terrace.

10 year VELUX guarantee.

Interior variants:

Pine with triple coat finish or white paint finish

Cladding variants:

Grey aluminium, titanium zinc, copper or other cladding types and colours

Pane variants:

(-73) Toughened outer pane with clear and clean coating and laminated inner pane for additional safety

For more pane variants see section 8.

Application

Operation

Maintenance

Guarantee

Variants

Roof terrace system can be combined with:

Flashings for

- Combi installation



Installation products

- Insulation collar
- Underfelt collar
- Vapour barrier



Interior variants:

Pine with triple coat finish or white paint finish

Cladding variants:

Grey aluminium, titanium zinc, copper or other cladding types and colours

Interior sunscreening

- Blackout blinds
- Roller blinds
- Pleated blinds
- Venetian blinds



Exterior suncreening

- Awning blind – for top element GEL only



Pane variants:

(-73) Toughened outer pane with clear and clean coating and laminated inner pane for additional safety

For more pane variants see Glazing section.

Combinations

Variants

Technical data – GEL+VEA/B/C

Cross-section/
measurements (mm)

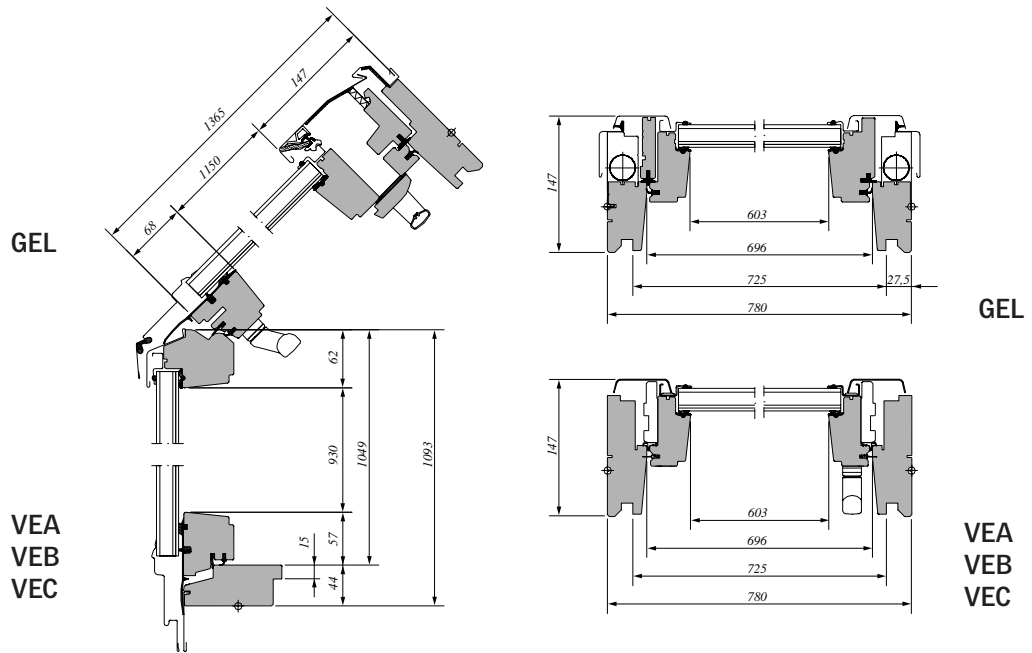

Sizes (cm)

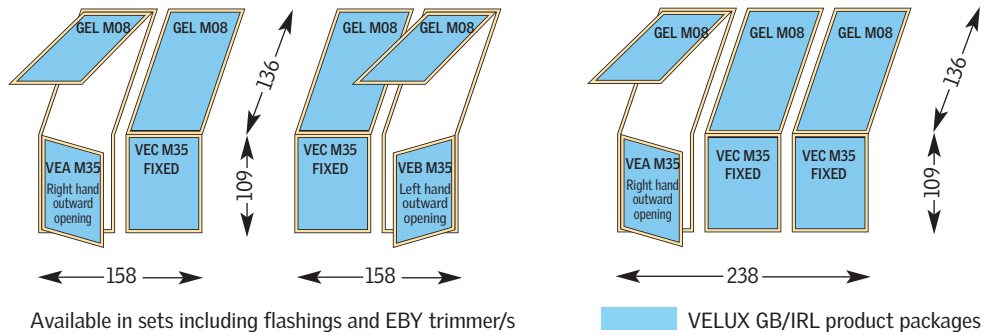

Available in sets including flashings and EBV trimmer/s

Technical data

	Size	M08	M35
Ventilation flap – free area [10 ³ mm ²]		4.3	-
Ventilation flap – equivalent area [10 ³ mm ²]*		3.7	-
Ventilation – open window [m ²]		0.89	0.64
Effective daylight area [m ²]	GEL VEA/B/C	0.69	0.56

*Measured to EN 13141-1

Pane variant	--73	EN/ISO Standard
Thermal transmittance, U _w [W/m ² K]	1.4	EN ISO 12567-2
Sound insulation, R _w [dB]	35	EN ISO 140-3/EN ISO 717-1
Air permeability	Class 3	EN 12207
Light transmittance, τ _v	0.77	EN 410
Total solar energy transmittance, g	0.54	EN 410