

VELUX Skylight installed in new metal roofing.

1. The sheets are fitted 100 mm from the bottom frame
2. The flashing is mounted
3. Fit the metal sheets

BASIS OF DESIGN:
VELUX Fixed
Skylight (FS)

VELUX Skylight installed in to existing metal roofing. **ELEVATIONS**

1. The metal sheet is cut to allow for the flashing apron.
The cut must stop on top of a profile
(min 270 mm from the side frame)
2. The filler piece is placed so it fits the cut
(can be fixed to the existing metal sheets with rivets)
(Shape the filler piece from the cut-out sheets of
the skylight)

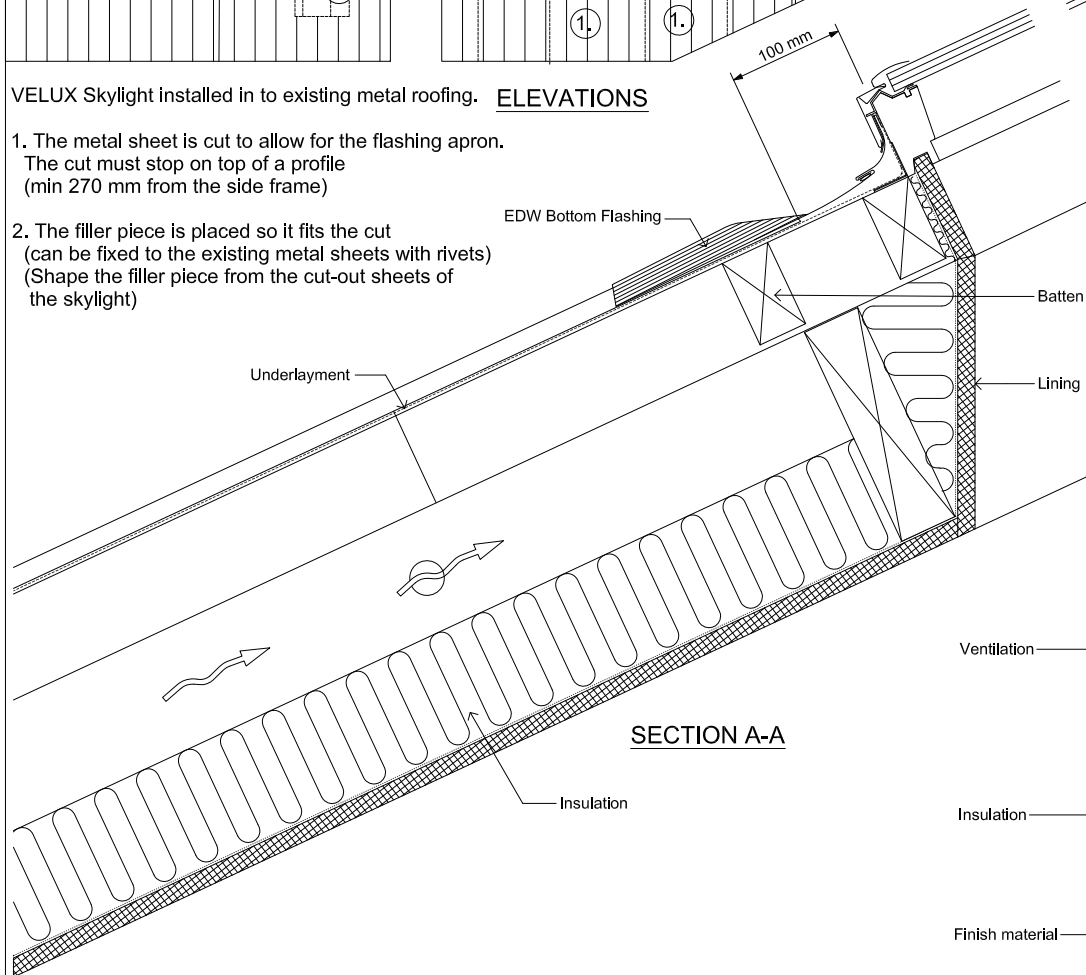

SECTION A-A

Ventilation

Insulation

Finish material

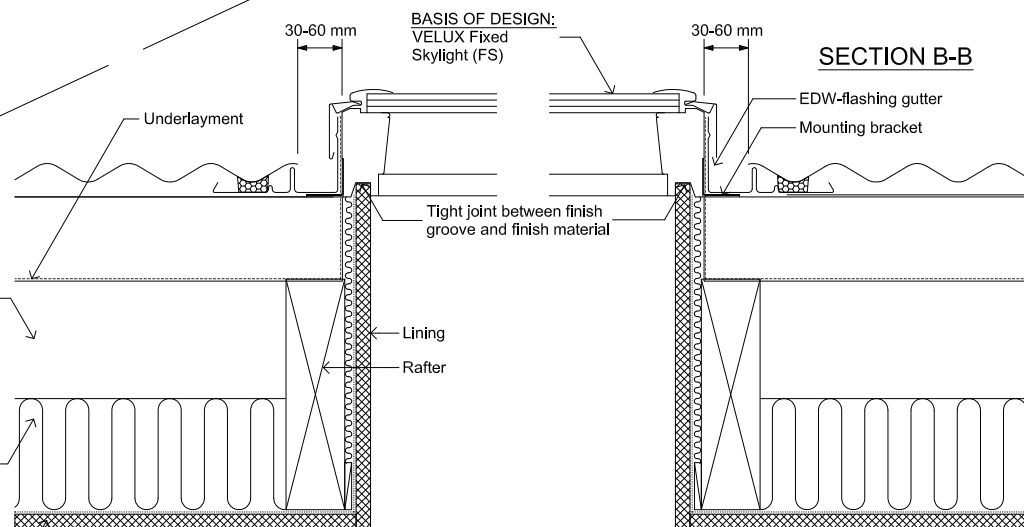

SECTION B-B

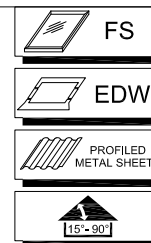

VELUX

Sky-Product Management

NEW ZEALAND LTD.

0800 650 445

FS - Fixed Skylight and EDW Flashing in Profiled Metal Roof

| Name | Date |
|-------------|---------|
| Drawn by | June 11 |
| Checked by | June 11 |
| Drawing No. | |