

Doorsnede A-A
1:5

	A	B
	mm	mm
15	50	40
20	55	45
25	60	45
30	65	50
35	70	55
40	75	60
45	85	65
50	90	75
55	105	85

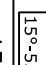

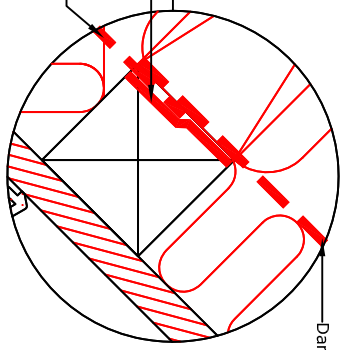

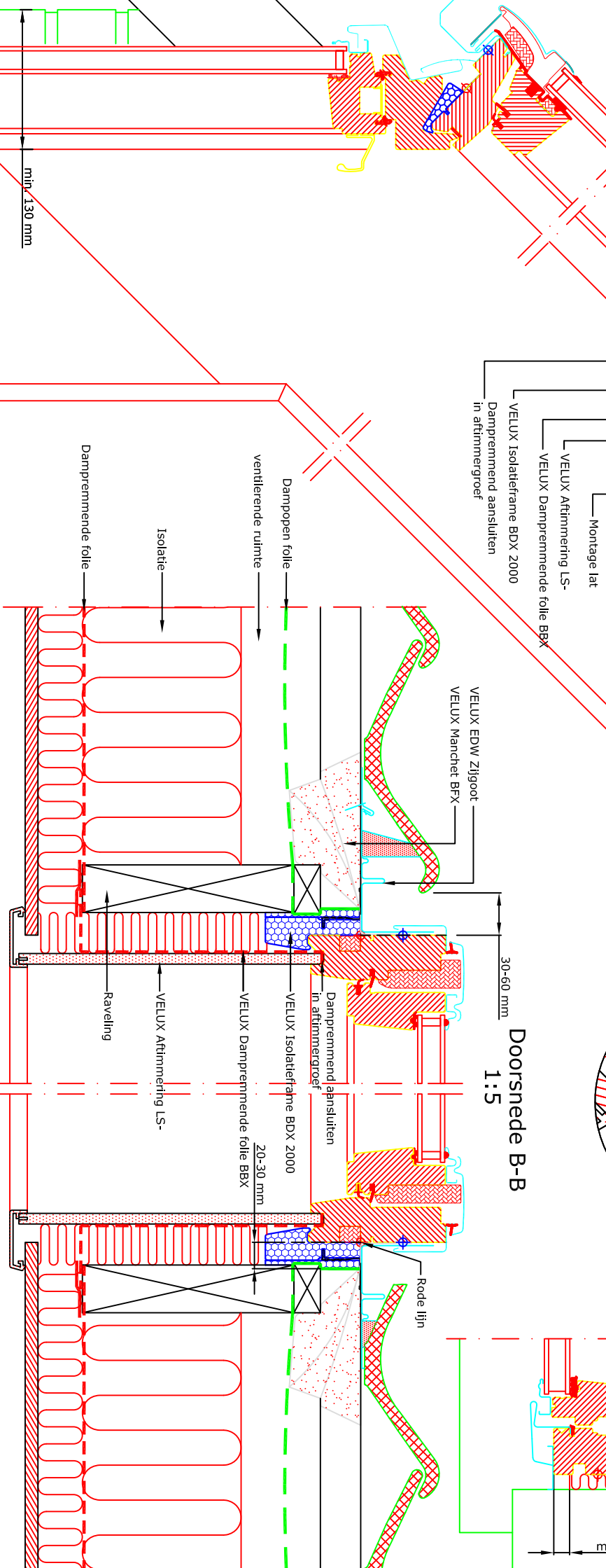

Doorsnede B-B
1:5

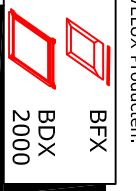

1:2.5

Doorsnede C-C
1:5

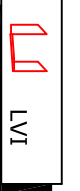
VELUX Producten:

-  BFV
-  BDX 2000
-  LS-BBX
-  LVI
-  Pannen

VELUX Producten:

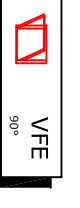
-  GGL 15°-90°
-  VFE 90°
-  EFW 15°-55°

Dakbedekking:

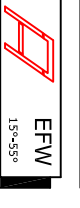
-  Dakbedekking

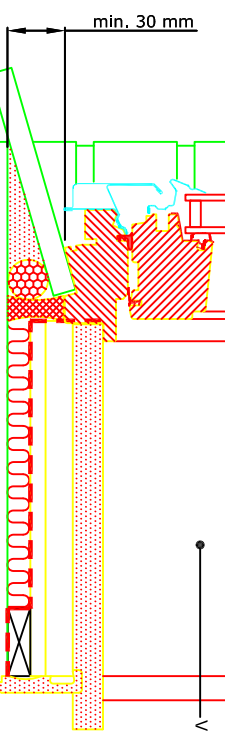

Let op:
De afgebeelde dakconstructie is slechts als richtlijn te beschouwen. Daarnaast dient de bestaande bouwregelgeving in acht worden genomen bij installatie van het VELUX dakraam.

© VELUX GROUP ® VELUX, VELUX logo are registered trademarks

VELUX

VELUX A/S

Meer dicht bij wooncomfort. Minder energieverbruik.

Date	19.12.12	File name	EFW+GGL+VFE-1212	Drawing no.	N10
All measurement in mm					

SCO