

Manual Controls

Out of Reach Skylights

Colour & Material

Silver / Grey. Aluminium, Plastic handle cover & hook.

Application

VELUX rod controls are used to operate openable skylights, manual blinds for skylights and manual blinds for roof windows in out of reach installations.



ZXT 200
ZXT 200 Extension Rod. The rod is a straight rod with a hook on the end, designed to hook into the handrail of manual blinds for FS pulling or pushing the rod will operate the blinds up or down.
Length: 1 metre – extends to 1.85 metres
For: Manual blinds



ZCT 300
ZCT 300 Extension Rod. The rod has a crank handle winder with a hook on the opposite end, which connects to a hook on the skylight. Turning the handle will open or close the skylight. One rod can operate multiple skylights.
Length: 1.45 metres – extends to 2.85 metres
For: VS and VCM Skylights

Within Reach Skylights

Colour & Material

Silver / Grey / White. Aluminium, Plastic handle cover & hook.

Application

VELUX in-reach controls are used to operate openable skylights and manual blinds for skylights.



ZOZ 032
ZOZ 032 Short Rod. The rod is a short version of the ZCT 300, and will operate a manual openable skylight within reach. One rod can operate multiple skylights.
Length: 60cm
For: VS and VCM Skylights



ZZZ 201 and ZZZ 212
ZZZ 201 Winder Handle. The winder handle is a crank handle fixed permanently onto the manual openable skylight. One handle is needed per skylight.
Length: 120mm
ZZZ 202 for: VS
ZZZ 212 for: VCM

Important Note

When determining the correct rod control needed, consider: Rod controls will be held in home owner's hands approximately 1.5 metres above floor level. An additional 1 metre extension can be ordered if needed.

Radio Frequency Control Systems

Sophisticated radio frequency control systems for VELUX Skylights & Blinds



Intelligent RF Control

The radio frequency signal from the remote control does not require direct line-of-sight to operate products, continuing to operate through most building materials (approx range 10m inside the home, 75m outdoors).

The controls feature improved functionality including wireless pairing, security codes and compatibility with home automated systems.

Using the KLF 200 interface, VELUX products can be linked with home automation or 'smart' systems (CBUS, Dynalite, etc) and can be used to operate up to 200 VELUX products. The interface can receive signals from a variety of external products including thermometers, timers, wind sensors, heat sensors, etc.

All controls/interface systems come with a standard plug for immediate 'plug-&-play' installations. All you need to supply is a standard power outlet (GPO).

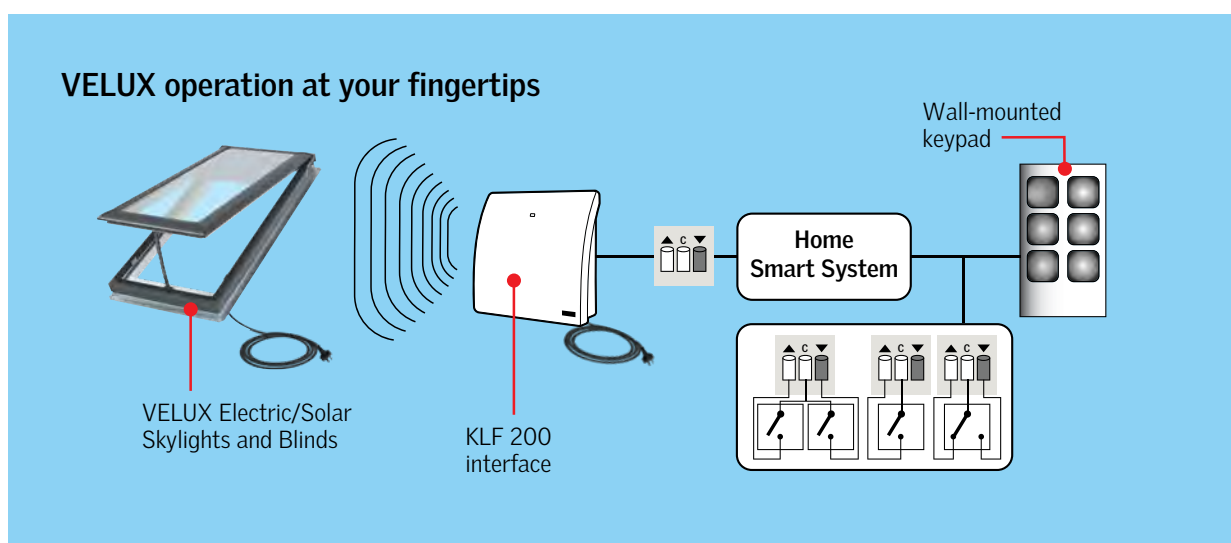



KLR 200 remote control

Application

- The KLR 200 is a 2.4 Ghz bi-directional, hand-held radio frequency remote control.
- Provided with VCS/VSS/VSE Skylight.^
- White ABS plastic and metallic grey paint.

Operation

- Can operate up to 200 Blinds or VSE/VSS/VCS Skylights. Individually or simultaneously.
- Remote signal does not need line-of-sight and can operate through most building materials.

Performance

- Operating distance-approx 10 meters indoors/75 meters outdoors.

Batteries supplied with all VELUX remote controllers.



KLF 200 interface

Application

- KLF 200 is a Home Automation interface used to link with Home Smart Systems (eg CBUS, Dynalite etc). It relays radio signals to existing VELUX Products.^
- White ABS plastic casing and cover.

Operation

- 2.4 Ghz bi-directional radio frequency unit.
- Comes complete with plug and cable to connect with a standard GPO power point (240 volt).
- VELUX products can be registered via the KLR 200 remote control.
- Operates up to 5 independent groups of products.

Performance

- Operating distance is approx 10 meters indoors/75 meters outdoors.
- Should be installed in a dry location.
- Operates up to 5 independent groups of products.



KLI 110 wall-mounted keypad

Application

- Operates VELUX electrical products individually or simultaneously.^
- White ABS plastic.

Operation

- Radio frequency, wireless operation, so no cable or plug installation required.
- Offers simple up/down/stop functionality.
- Supplied with Solar blinds (DSH/DSD/DSC models).

^ Not suitable for VELUX products manufactured prior to April 2010.