

Radio Frequency Control Systems

Sophisticated radio frequency control systems for VELUX Skylights & Blinds



Intelligent RF Control

The radio frequency signal from the remote control does not require direct line-of-sight to operate products, continuing to operate through most building materials (approx range 10m inside the home, 75m outdoors).

The controls feature improved functionality including wireless pairing, security codes and compatibility with home automated systems.

Using the KLF 200* interface, VELUX products can be linked with home automation or 'smart' systems (CBUS, Dynalite, etc) and can be used to operate up to 200 VELUX products. The interface can receive signals from a variety of external products including thermometers, timers, wind sensors, heat sensors, etc.

All controls/interface systems come with a standard plug for immediate 'plug-&-play' installations. All you need to supply is a standard power outlet (GPO).

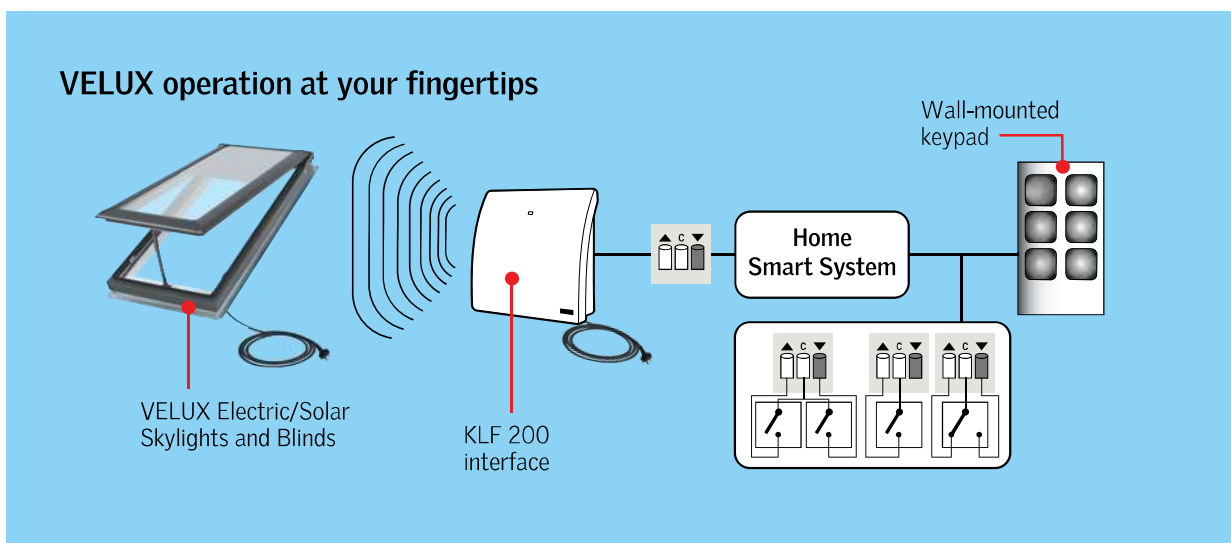



KLR 200 remote control

Application

- The KLR 200 is a 2.4 Ghz bi-directional, hand-held radio frequency remote control.
- Provided with VCS/VSS Skylight.^
- White ABS plastic and metallic grey paint.

Operation

- Can operate up to 200 Blinds or VSE/VSS/VCS Skylights. Individually or simultaneously.
- Remote signal does not need line-of-sight and can operate through most building materials.

Performance

- Operating distance-approx 10 meters indoors/75 meters outdoors.

Batteries supplied with all VELUX remote controllers.



KLF 200 interface

Application

- KLF 200 is a Home Automation interface used to link with Home Smart Systems (eg CBUS, Dynalite etc). It relays radio signals to existing VELUX Products.^
- White ABS plastic casing and cover.

Operation

- 2.4 Ghz bi-directional radio frequency unit.
- Comes complete with plug and cable to connect with a standard GPO power point (240 volt).
- VELUX products can be registered directly to the KLF 200/or via the KLR 200 remote control.
- Operates up to 5 independent groups of products.

Performance

- Operating distance is approx 10 meters indoors/75 meters outdoors.
- Should be installed in a dry location.
- Operates up to 5 independent groups of products.



KLI 110 wall-mounted keypad

Application

- Operates VELUX electrical products individually or simultaneously.^
- White ABS plastic.

Operation

- Radio frequency, wireless operation, so no cable or plug installation required.
- Offers simple up/down/stop functionality.
- Supplied with Solar blinds (DSH/DSD/DSC models).

^ Not suitable for VELUX products manufactured prior to April 2010.